



The centre piece of the rejuvenated park will be the red 'licorice sticks' play structure – a place for imaginative play, tag, climbing or strength training. Short height stepping logs will be nearby, serving as balance and agility structures for younger children and functioning as impromptu seating arrangements.



New play structures throughout the park will appeal to a wide range of children! (concept plans)

**Thank you to our supporters:**



Email: [bigplans@nutana.ca](mailto:bigplans@nutana.ca) | Facebook: [facebook.com/BigPlansForALittlePark](https://facebook.com/BigPlansForALittlePark) | Web: [nutana.ca/big-plans-for-a-small-park/](http://nutana.ca/big-plans-for-a-small-park/)



Today



Big Plans



# HELP MAKE OUR LITTLE PARK A BIG SUCCESS!

The **Albert Recreation Unit**, on the corner of Clarence and 13<sup>th</sup> Street, has been a little park used by Nutana and Varsity View residents for over 70 years. While the park has served us well, it is beginning to show its age. Our **Big Plans** committee was formed over a year ago to plan for its rejuvenation.

Now, after much work reviewing the park's facilities, getting feedback from the community and doing research and planning, our **Big Plans for a Little Park** are close to being finalized!

Overall, we focused on these goals:

- maintain the paddling pool and building
- increase the green space
- modernize the playground equipment
- make the park a safe and welcoming place for all in our neighbourhoods

We believe those goals have been well met!

We have tried to pack as much big fun into this little park as we can – making it a destination for all ages and all interests. The committee has been working with Oxbow Architecture – one of firms involved with the refurbished Kinsmen Park – to realize many of our goals with innovative

and creative solutions. We are sure you will agree that the new park plans are a much needed improvement.

**Highlights of the new plans include:**

- New play structures throughout the park
- Twisty sticks climbing and play structure
- A larger grassed area, with a small hill incorporating a slide
- Retaining the awesome paddling pool and established trees of the park
- New basketball half-court
- Planted tree play orchard near the south entrance to the park
- New fitness stations
- Natural play areas
- More open areas for crafts and play

These may be big plans for our little park, but we believe that the neighbourhood deserves and will support a great little park like this.

Please consider donating and help us make our little park a Big Success!

  
Rahul Mairra,  
Chair, Big Plans for a Little Park Committee

# Concept plans:

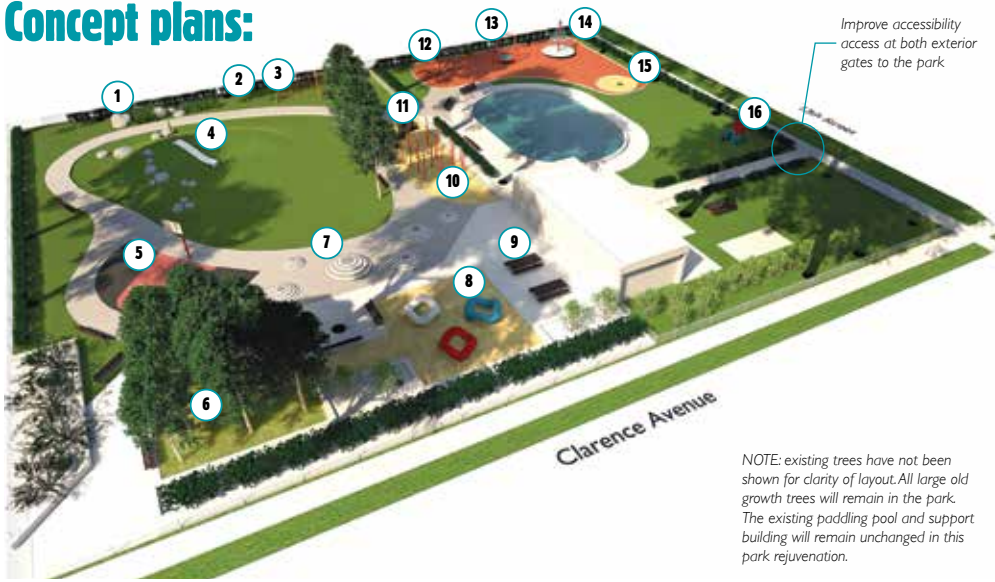

NOTE: existing trees have not been shown for clarity of layout. All large old growth trees will remain in the park. The existing paddling pool and support building will remain unchanged in this park rejuvenation.

<p><b>1</b></p> <p>Natural environment play area with rocks – a chance to explore the wild side!</p>	<p><b>2</b></p> <p>Fitness stations for warm up, cool down, strength training and for general play, too.</p>	<p><b>3</b></p> <p>Climbing and agility structure, for challenging play and exercise.</p>	<p><b>4</b></p> <p>Small grassed hill with a built-in slide and climbing rocks. Can be used as a sledding hill in winter.</p>
<p><b>5</b></p> <p>Basketball half-court – take on your pals in a friendly match!</p>	<p><b>6</b></p> <p>Small grove of trees marks the entry to the park. A quiet area for contemplation, relaxation, play and to reconnect to a natural environment.</p>	<p><b>7</b></p> <p>Asphalt mounds for climbing, playing, hiding, jumping or wherever your mind takes you. Fun graphic painted line elements bring out your imagination.</p>	<p><b>8</b></p> <p>Climbing structures to engage the physical elements of play.</p>
<p><b>9</b></p> <p>Craft area with picnic tables – an ideal spot to sit and paint, read, or eat your lunch in the shade of the trees.</p>	<p><b>10</b></p> <p>'Licorice' sticks – curved metal poles for play, tag, climbing and making up games.</p>	<p><b>11</b></p> <p>Stepping logs to test your balance and skill. Also provides natural sitting areas for quiet and waiting times.</p>	<p><b>12</b></p> <p>New swing set, with improved safety fall zones, all on a rubber play surface.</p>
<p><b>13</b></p> <p>Dish swing for multiple children together – play is always better with friends!</p>	<p><b>14</b></p> <p>Spinning Cone Climber because the only thing more fun than spinning, is spinning and climbing at the same time!</p>	<p><b>15</b></p> <p>Sandbox for the very young and the young at heart.</p>	<p><b>16</b></p> <p>Cut out play structures for the young and curious.</p>

## Ready to do a Good Deed?

We are asking the neighbourhood to do a good deed and contribute towards the funds needed to make these Big Plans a reality.

In return, we'll give you a **Good Deed for a Little Park** as a thank you for any donation over \$100 and you will be helping to make our little park a Big Success!

### How it works:

The Albert Recreation Unit is a little park about 3000 m<sup>2</sup> in size. To raise money for the park's rejuvenation, we are figuratively dividing the park into blocks of approximately one square metre in size and asking the community to donate \$100, or more, per square metre.

With your generosity we aim to raise the **\$300,000** to cover the costs of the rejuvenation.

You are welcome to donate the equivalent of one square metre block, or for several blocks of the park. Our Big Plans committee will issue an official

'Good Deed' thank you for any donation of \$100 or more, and tax receipts will be issued by the City of Saskatoon for all donations. Donors at \$500 and above will also be recognized in the park.

This project has great community support, with over \$60,000 already committed with grants from the **City of Saskatoon**, the **Nutana and Varsity View Community Associations**, the **Community Initiatives Fund** and with donations from your friends and neighbours!

The City of Saskatoon has also received a special grant from the **Canada 150 Fund**, which will be used for some of the new play structures – and while it will be a separate project, it will be integrated into the new larger park plan.

These may be big plans for our little park, but we believe that the neighbourhood deserves and will support a great little park like this. Do a good deed for your neighbourhood today – donate now!

*Thank you for making our little park a BIG success!*



## Yes! I want to help make our little park a BIG success! Here is my donation!

All donations of \$100 and above will receive a Good Deed document. Donors at \$500 and above will also receive recognition in the park. All donations will receive a tax receipt from the City of Saskatoon.

Name: \_\_\_\_\_

Business/Corporation: \_\_\_\_\_

Address: \_\_\_\_\_

City: \_\_\_\_\_

Province: \_\_\_\_\_ Postal Code: \_\_\_\_\_

Phone: \_\_\_\_\_ Email: \_\_\_\_\_

### Make your donation and get your Good Deed!

#### Donation Amount:

- \$100 (1 m<sup>2</sup>)   
  \$300 (3 m<sup>2</sup>)   
  \$500 (5 m<sup>2</sup>)  
 \$1 000 (10 m<sup>2</sup>)   
  \$2 000 (20 m<sup>2</sup>)   
  \$5 000 (50 m<sup>2</sup>)  
 \$10 000 (100 m<sup>2</sup>)   
  Other \$ \_\_\_\_\_

#### Donor recognition:

- Use the name listed for recognition  
 Use this name for recognition: \_\_\_\_\_  
 Recognition in memory of: \_\_\_\_\_  
 Anonymous donation

**IMPORTANT:** Please make cheques payable to: **City of Saskatoon**. Mark the cheque with "Albert Rec Unit".

Tax receipts will be issued for donations in the above name unless specified otherwise here: \_\_\_\_\_

#### Mail your donation and this form to:

Nutana Community Association, c/o École Victoria School, 639 Broadway Avenue, Saskatoon, SK S7N 1B2

OR donate online here: <http://nutana.ca/big-plans-for-a-small-park/>